



Important aspects

Solution

Vagus

Housing CVERNA

Background

We continue!

Impact

Housing first



Background
of project housing Cverna
in 2017



0,4%



Slovakia and city
of Bratislava

=

no reflection of
housing problem





0,4%

percentage of
rental apartments owned by
the city of Bratislava

The infographic features a large teal circle on a grey background. Inside the teal circle is a smaller white circle containing the number '4500' in orange. Below the white circle is a white ampersand '&'. Underneath the ampersand, the text 'high level of prejudice against social housing among local and state politicians' is written in white. A yellow triangle is visible in the top-left corner of the overall image.

4500

homeless people

&

high level of prejudice
against **social housing** among
local and state politicians



Important aspects

Solution

Vagus

Housing CUERNA

Background

We continue!

Impact

Housing first

**only solution
=
private or
non-governmental
sector**

private
companies

NGO

ΝΑΔΆCΙΑ
CVERNOVKA

construction
developers
vs.
social housing



construction
developers

vs.

social housing



too daring



non-governmental sector

open mind

creative center Cvernovka



non-governmental sector



open mind

creative center Cvernovka

non-governmental sector



open mind



creative center Cvernovka

non-governmental sector



open mind



creative center Cvernovka





NOVÁ ČVERNOUŠKA?





A dark grey circle is centered on a light grey background. Inside the circle, the text "art studios" is written in orange at the top. Below it, "offices and housing" is written in yellow. To the left of this text, three white curved arrows point downwards and to the right, suggesting a flow or relationship between the text elements.

art studios

offices and housing

A dark gray circle is centered on a light gray background. Inside the circle, there is a list of items. The first item, 'art studios', is in orange. The second item, 'offices and housing', is in yellow. The third item, 'in an abandoned chemical high school building and dormitory building', is in white. There are four white arrows pointing from the left side of the circle towards the text. The first arrow points to 'art studios', the second to 'offices and housing', the third to 'in an abandoned chemical high school building and dormitory building', and the fourth to the bottom left of the circle.

art studios

offices and housing

in an abandoned chemical
high school building and
dormitory building

art studios

offices and housing

in an abandoned chemical
high school building and
dormitory building

Housing Cverna
project

art studios

offices and housing

in an abandoned chemical
high school building and
dormitory building

Housing Cverna
project

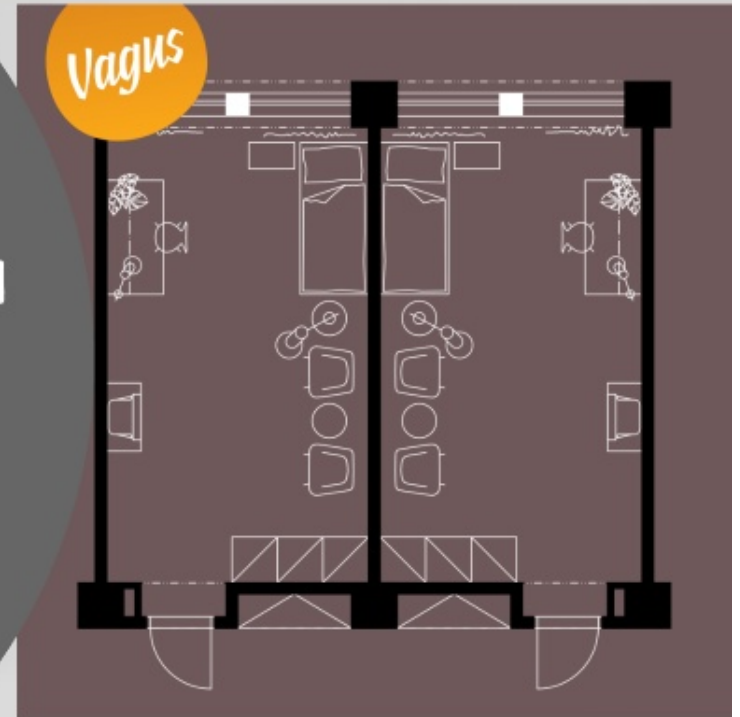



Important aspects

Solution

Vagus

Housing
CUERNA

Background

Housing first

Impact

We continue!



Important aspects of Housing Cverna project



3
accommodation units
=
Cvernovka Foundation



a strong team for
social counseling

know-how in
approaches



**interior quality as an
aspect of quality of life**
(even more important
in the case of socially
excluded people)
**= Plural architects
and IKEA**

IKEA

Bratislava



PLURAL

architects

community influence
as a factor accelerating
integration

**= residents of former
dormitory** (artists,
students and residents of
creative center)



financing
= Telekom Foundation
and city of Bratislava





Important aspects

Solution

Vagus

Housing CUERNA

Background

We continue!

Impact

Housing first



Housing First
approach
vs.
another
social housing
approaches

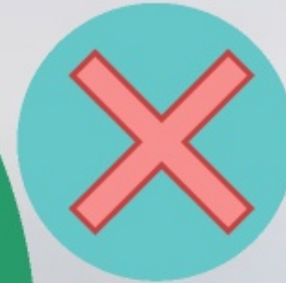



**What could not
be done in our
conditions?**

1. lifetime lease
2. housing for the most complicated tenants

Directly from the street to housing

1st month for acclimatization

Long-term intensive socio-psychological support from our team of experts

Fair lease for as long as possible (minimum 3 years guaranteed)

Progressively rising rental payments that respect the tenant's options

An approach of our team that motivates and encourages tenants to find their own long-term goals

As few rules as possible = freedom commits

The same terms of the lease as for the other tenants



Directly from the street to housing

1st month for acclimatization

Directly from the street to housing

1st month for acclimatization

Directly from the street to housing

1st month for acclimatization

Long-term intensive socio-psychological support from our team of experts

Fair lease for as long as possible (minimum 3 years guaranteed)

Progressively rising rental payments that respect the tenant's options

Long-term intensive socio-psychological support from our team of experts

Fair lease for as long as possible (minimum 3 years guaranteed)

Progressively rising rental payments that respect the tenant's options

Long-term intensive socio-psychological support from our team of experts

Fair lease for as long as possible (minimum 3 years guaranteed)

Progressively rising rental payments that respect the tenant's options

Approach of our team that motivates and encourages tenants to find their own long-term

As few rules as possible = freedom commits

Long-term intensive socio-psychological support from our team of experts

Fair lease for as long as possible (minimum 3 years guaranteed)

Progressively rising rental payments that respect the tenant's options

An approach of our team that motivates and encourages tenants to find their own long-term goals

As few rules as possible = freedom commits

The same terms of the lease as for the other tenants

am that motivates and encourages tenants to find the

As few rules as possible = freedom commmits

The same terms of the lease as for the other tenants

As few rules as possible = freedom commits

The same terms of the lease as for the other tenants



Important aspects

Solution

Vagus

Housing CVERNA

Background

Housing first

Impact

We continue!





Impact
after
10 months

tenants

society



impact
on tenants

A photograph of a room, possibly a dormitory or a small apartment, featuring a bed with white linens, a white cabinet, and a trash bin. A large blue circle is overlaid on the image, partially obscuring the bed and cabinet. The text "3 residential units" is written in white at the top of the blue circle.

3 residential units

impact
on tenants



3 residential units

great feedback
directly from tenants

impact
on tenants



3 residential units

4 tenants who are part of
the project without any
problems

great feedback
directly from tenants

impact
on tenants



3 residential units

4 tenants who are part of
the project without any
problems

great feedback
directly from tenants

new and strong tenant goals in the
process of social change
tenants themselves have found
employment

impact
on tenants

3 residential units

4 tenants who are part of
the project without any
problems

great feedback
directly from tenants

new and strong tenant goals in the
process of social change
tenants themselves have found

no payment delays

employment

impact
on tenants

3 residential units

**4 tenants who are part of
the project without any
problems**
great feedback
directly from tenants

**new and strong tenant goals in the
process of social change
tenants themselves have found**

no payment delays **employment**

no unresolved issue in the community

impact
on tenants

3 residential units

4 tenants who are part of
the project without any
problems
great feedback
directly from tenants

new and strong tenant goals in the
process of social change
tenants themselves have found

no payment delays
employment

no unresolved issue in the community

our tenants point out
violations of others' rules

impact
on tenants



impact
on society



example of great
practice

impact
on society

A photograph of a kitchen area, showing a white sink and a grey trash bin. A large, semi-transparent pink circle is overlaid on the left side of the image. The text "example of great practice" is written in white inside the top part of the pink circle. The text "membership in working groups focused on social housing" is written in white inside the middle part of the pink circle. The text "impact on society" is written in a dark grey font on the right side of the image, partially overlapping the trash bin.

example of great
practice

membership in working
groups focused on social
housing

impact
on society



**example of great
practice**

**cooperation with the city in the area
of long-term housing of our tenants
- rental apartments of the city**

**membership in working
groups focused on social
housing**

**impact
on society**

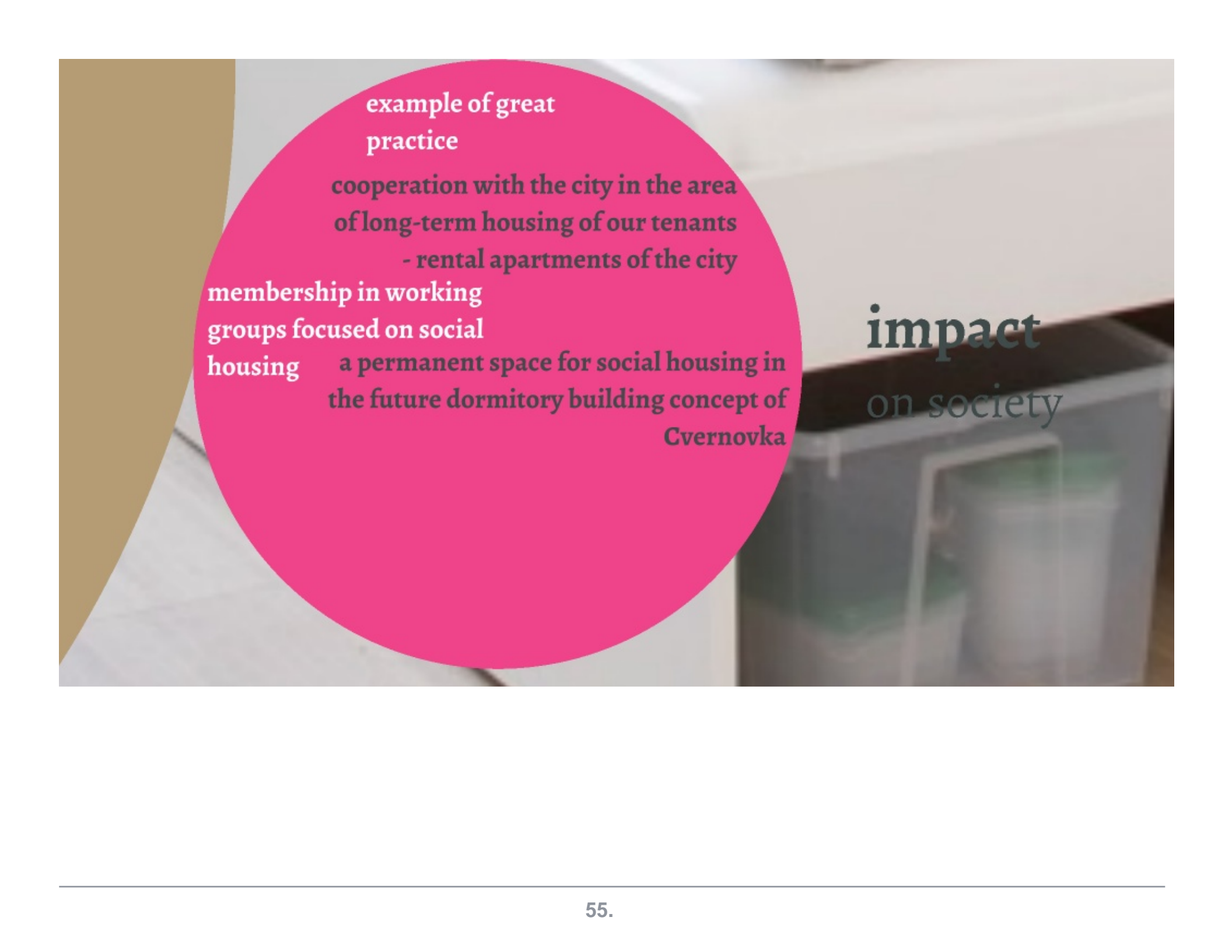

**example of great
practice**

**cooperation with the city in the area
of long-term housing of our tenants
- rental apartments of the city**

**membership in working
groups focused on social
housing**

**a permanent space for social housing in
the future dormitory building concept of
Cvernovka**

**impact
on society**

**example of great
practice**

**cooperation with the city in the area
of long-term housing of our tenants
- rental apartments of the city**

membership in working

groups focused on social

housing

**a permanent space for social housing in
the future dormitory building concept of**

Cvernovka

dozens of positive articles

and media coverage = public support

= prejudice reduction

**impact
on society**

**example of great
practice**

**cooperation with the city in the area
of long-term housing of our tenants
- rental apartments of the city**

membership in working

groups focused on social

housing

**a permanent space for social housing in
the future dormitory building concept of**

Cvernovka

dozens of positive articles

and media coverage = public support

= prejudice reduction

**social discussion about social
housing and access Housing first**

**impact
on society**



Important aspects

Solution

Vagus

Housing
CVERNA

Background

Housing first

Impact

We continue!



social housing
as a solution to
homelessness
We continue!







integration center +
preparation for new flats

We
continue



integration center +
preparation for new flats

**IKEA as a permanent theme
partner in the Central
European region**

**We
continue**



integration center +
preparation for new flats

the new political leadership of the city,
where social housing is directly in the
philosophy of urban strategic plans

IKEA as a permanent theme
partner in the Central
European region

We
continue



integration center +
preparation for new flats

the new political leadership of the city,
where social housing is directly in the
philosophy of urban strategic plans

my new job at the Bratislava City Hall
- Mayor's representative for
Homeless People
and Social Housing

IKEA as a permanent theme
partner in the Central
European region

We
continue



Important aspects

Solution

Vagus

Housing CVERNA

Background

We continue!

Impact

Housing first



“When you are on the street, you always think that where you go to sleep, I no longer have to deal with this question. Now I can finally deal with other things that are also important.”

“First, I had a morning coffee. And a good bath in the bath. There are only showers in charities everywhere, and after all these years, it was an incredible change.”

“A man on the street has nothing but himself and the motivation to survive. You have no place to put away personal belongings like in an apartment. So now I enjoy everything I have.”

Marta, tenant of Housing Cverna project